

TRIMMER



INSTRUCTIONS	COL. NO.
219719-001-000	1

USE ONLY GENUINE OSTER PARTS
USE OF WRONG PARTS MAY BE HAZARDOUS.

NEW MODELS ADDED ⇒ FIRST ISSUE 5/ 89 COLUMN #: 1, #2																		
		1	2	3	4	5	6	7	8	9	10	11						
CHARGER INPUT : 120 VAC. 60HZ																		
1.2 VDC, 1.23 W																		
MODEL OR SERVICE NO. COLUMN →		1	2	3	4	5	6	7	8	9	10	11						
INDEX NO.	PART NUMBER	* WAS PART NO.	DESCRIPTION	Basic Parts	197-01A	219805	197-02A	197-10-A										
					QUANTITY REQUIRED													
1	058221-005-000	219805-001	ADAPTOR CHARGING	1														
2	058512-015-000	221683	TRIMMER ASSY W/O BLADES	1	1													
2	058512-010-000	221683-002	TRIMMER ASSY W/O BLADES				1											
2	058512-005-000	221683-001	TRIMMER ASSY W/O BLADES					1										
3	058225-000-000	219812	DRIVE BLADE	1														
4	046786-000-000	913-60	BLADE SET	1														
5	055114-005-000	219801	SCREW SPECIAL	2														
6	058284-005-000	220004-001	COMB 3/8"	1														
7	058594-000-000	600009	COMB 1/8"	1														

* PARTS ARE INTERCHANGEABLE, USE UP EXISTING STOCK.

MANUAL: PROFESSIONAL PRODUCTS

CONTINUED ON REVERSE SIDE

SECTION: CLIPPERS

www.TheEdgePro.com

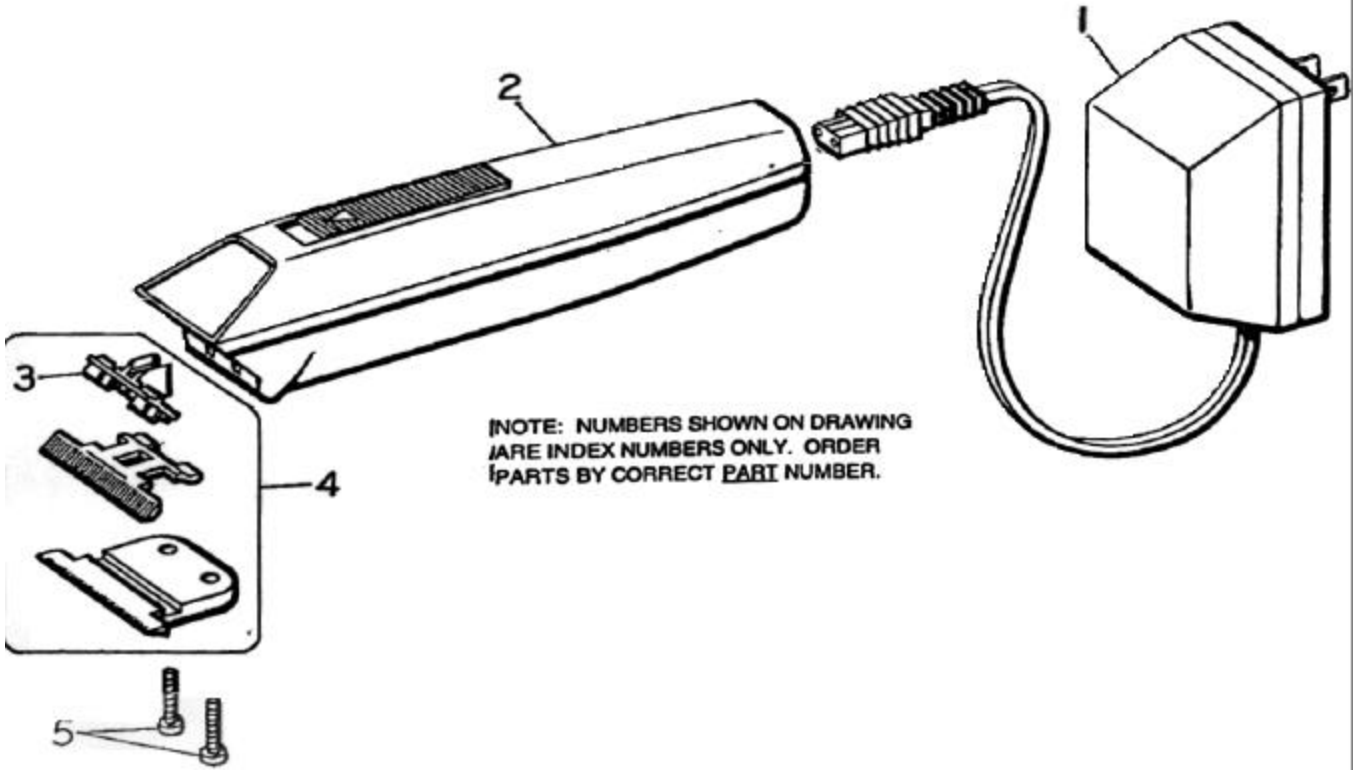
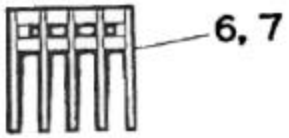

NOTE: NUMBERS SHOWN ON DRAWING ARE INDEX NUMBERS ONLY. ORDER PARTS BY CORRECT PART NUMBER.

www.The