

PARTS LIST
GROUP II CLIPPERS



INSTRUCTIONS	COL. NO.
106349	BASIC

NEW MODELS ADDED ⇨ FIRST ISSUE	COLUMN #:										
GRAPHITE METALLIC	X										
ELECTRO SILVER		X									
ONE SPEED		X									
TWO SPEED	X										
120 VOLTS, 45 WATTS, AC	X	X									
MODEL OR SERVICE NO. COLUMN →	1	2	3	4	5	6	7	8	9	10	11

INDEX NO.	PART NUMBER	* WAS PART NO.	DESCRIPTION	Basic Parts	QUANTITY REQUIRED															
					078005-140-002	078005-141-002	078005-010-002	078005-011-002	078005-050-002											
1	106942-000-000		SCREW,#6X1/2,TWIN HELIX	2																
2	115286-010-699		COVER-GRAPHITE METALLIC		1															
2	115286-010-599		COVER ELECTRO SILVER			1														
3	113516-032-000		NAMEPLATE, 2 SPD		1															
3	113516-031-000		NAMEPLATE, 1 SPD			1														
5	115544-000-000	109547-000-000	CAPTURE PLATE	1																
6	044946-005-000	044946-000-000	LEVER	1																
7	045515-000-000		LINK	1																
8	041723-000-000		GREASE SEAL	2																
9	111012-010-000	111012-050-000	BRUSH CAP-BLACK	2																
9	111012-070-000	111012-060-000	BRUSH CAP-GRAPHITE				2													
10	042584-025-000	042584-020-000	BRUSH & SPRING ASSY	2																
11	042566-000-000		THRUST PLATE	1																
12	105520-000-000		GEAR (TWO SPEED)		1															
12	058908-000-000		GEAR (SINGLE SPEED)			1														
13	108692-120-005	108783-050-000	HSG-MOTOR-MACH, GRAPHITE METALLIC		1															
13	108692-110-005	108783-060-000	HSG-MOTOR-MACH, ELECTRO SILVER				1													
14	058543-000-000		WASHER-THRUST	1																
15	044941-000-000		HINGE ASSEMBLY	1																
16	109189-000-000		SCREW,#6X.375,PHND	2																
17	045588-000-000		BLADE GUARD	1																
18	111038-050-000		LABEL,DATA,5-14C		1															
18	111038-060-000		LABEL,DATA,5-01L			1														
20	042571-000-000		BLADE GUIDE	1																
22	044936-000-000		SOCKET	1																
25	042555-000-000		BLADE SCREW- #6-32 X 7/32	2																
26	057070-000-000		BEARING	2																
27	042568-000-000		WASHER-FELT	2																
29	058519-000-000		BEARING RETAINER	2																
30	042114-050-000		SCREW	2																
31	042872-000-000		Screw - #6-32 X 1/4	2																
32	084935-000-000		ARMATURE ASSY. - 2 SPEED 120V		1															
32	084934-005-000		ARMATURE ASSY. - 1 SPEED 120V			1														
33	084936-000-000	084936-005-000	FIELD ASSY - 120V		1															
34	044938-000-000		LATCH	1																
35	042557-000-000		LOCATING RING	1																
36	042559-000-000		CUP-THRUST SPRING	1																
37	042562-000-000		THRUST SPRING	1																
38	058006-000-000		MOTOR END FRAME ASSY.	1																
42	042570-000-000		RETAINING CUP	1																
44	058172-005-000		SWITCH ASSY-2SPD		1															
44	104365-000-000		SWITCH ASSY-1SPD			1														
45	111013-010-000	111013-050-000	VENT(W/SCREEN) BLACK		2															
45	111013-070-000	111013-060-000	VENT(W/SCREEN) GRAPHITE			2														
46	108780-010-000	108780-050-000	END CAP,TOGGLE, BLACK		1															
46	108780-070-000	108780-060-000	END CAP,TOGGLE, GRAPHITE			1														
47	041756-000-000		LOCKWASHER	2																
48	042574-000-000		SCREW - #6-32 X 1 1/8	2																
49	058168-000-000		SWITCH NUT	1																
50	042614-000-000		BRUSH RETAINER ASSY.	2																
51	042573-000-000		BALE	1																
52	042551-000-000		RETAINING RING	1																
55	110737-000-000		CORD WSR,POLARIZED		1	1														
62	042564-000-000		SCREW- #4-36 X 3/16	2																
74	041680-000-000		GREASE 1 LB																	
75	042113-015-000		SCREW-BT	3																
79	058355-000-000		TERMINAL BRACKET	2																
80	085043-000-000		LABEL, HI-LOW		1															
	041664-000-000		SCREW	1																

SEE PAGE 2A FOR BLADE SET & TENSION SPRING CHART. BLADE ADJUSTMENT SPECS AND BUSHING & RIVET SET INFORMATION.



BEFORE ASSY OF GEAR (12), FILL GEAR STUD WITH GREASE (74). GREASE MUST SQUIRT OUT OF BOTH HOLES IN STUD AND LEAVE STUD FULL OF GREASE. AFTER ASSY. OF GEAR (12) TO STUD, INJECT APPROX. 25g (1/2 sp) OF GREASE (74) BETWEEN GEAR (12) AND THRUST PLATE (11). A PORTION OF THIS GREASE MUST BE ON CAM AREA OF GEAR (12).

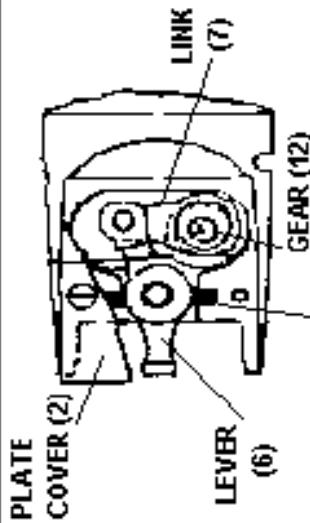

AFTER ASSEMBLY OF LEVER (6) & GREASE SEALS (8), THOROUGHLY SATURATE GREASE SEALS WITH CLIPPER OIL.

CAPTURE PLATE (5), MUST BE ASSEMBLED OVER GEAR STUD, WITH STUD PENETRATING HOLE IN CAPTURE PLATE (5). PLATE COVER (2) IS THEN PLACED ON TOP OF CAPTURE PLATE (5) AND SCREWS (1) DRIVEN TO SECURE.

END CAP SHOWN ASSEMBLED - FOR REFERENCE ONLY -

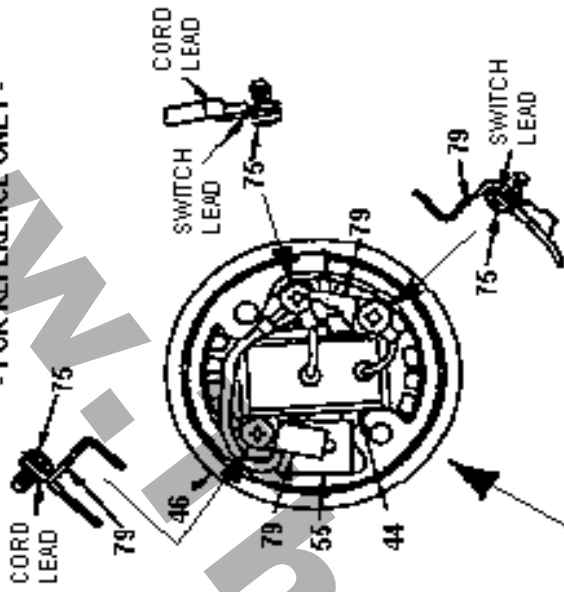

USE NO.3 TRU-ARC PLIERS OR EQUIVALENT TO REMOVE OR ASSEMBLE RETAINING RING

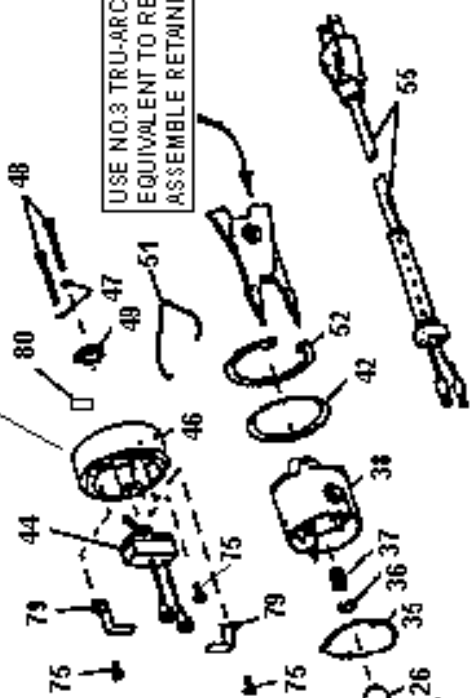

SATURATE WITH CLIPPER OIL BEFORE ASSEMBLY

SATURATE WITH CLIPPER OIL BEFORE ASSEMBLY

NOTE: NUMBERS SHOWN ON DRAWING ARE INDEX NUMBERS ONLY. ORDER PARTS BY CORRECT PART NUMBER.

SEE PAGE 2A FOR BLADE SET & TENSION SPRING CHART, BLADE ADJUSTMENT SPECS AND BUSHING & RIVET SET INFORMATION.

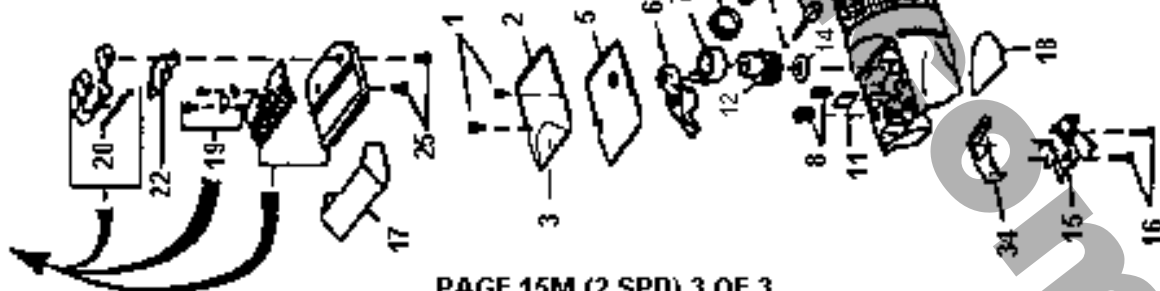

BEFORE ASSY OF GEAR (12), FILL GEAR STUD WITH GREASE (74). GREASE MUST SQUIRT OUT OF BOTH HOLES IN STUD AND LEAVE STUD FULL OF GREASE. AFTER ASSY. OF GEAR (12) TO STUD, INJECT APPROX. 25g (1/2 sp) OF GREASE (74) BETWEEN GEAR (12) AND THRUST PLATE (11). A PORTION OF THIS GREASE MUST BE ON CAM AREA OF GEAR (12).

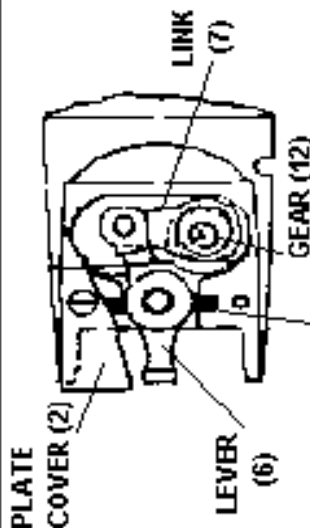

AFTER ASSEMBLY OF LEVER (6) & GREASE SEALS (8), THOROUGHLY SATURATE GREASE SEALS WITH CLIPPER OIL.

CAPTURE PLATE (5), MUST BE ASSEMBLED OVER GEAR STUD, WITH STUD PENETRATING HOLE IN CAPTURE PLATE (5). PLATE COVER (2) IS THEN PLACED ON TOP OF CAPTURE PLATE (5) AND SCREWS (1) DRIVEN TO SECURE.

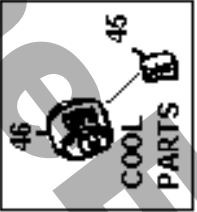

SATURATE WITH CLIPPER OIL BEFORE ASSEMBLY

SATURATE WITH CLIPPER OIL BEFORE ASSEMBLY

END CAP SHOWN ASSEMBLED - FOR REFERENCE ONLY -

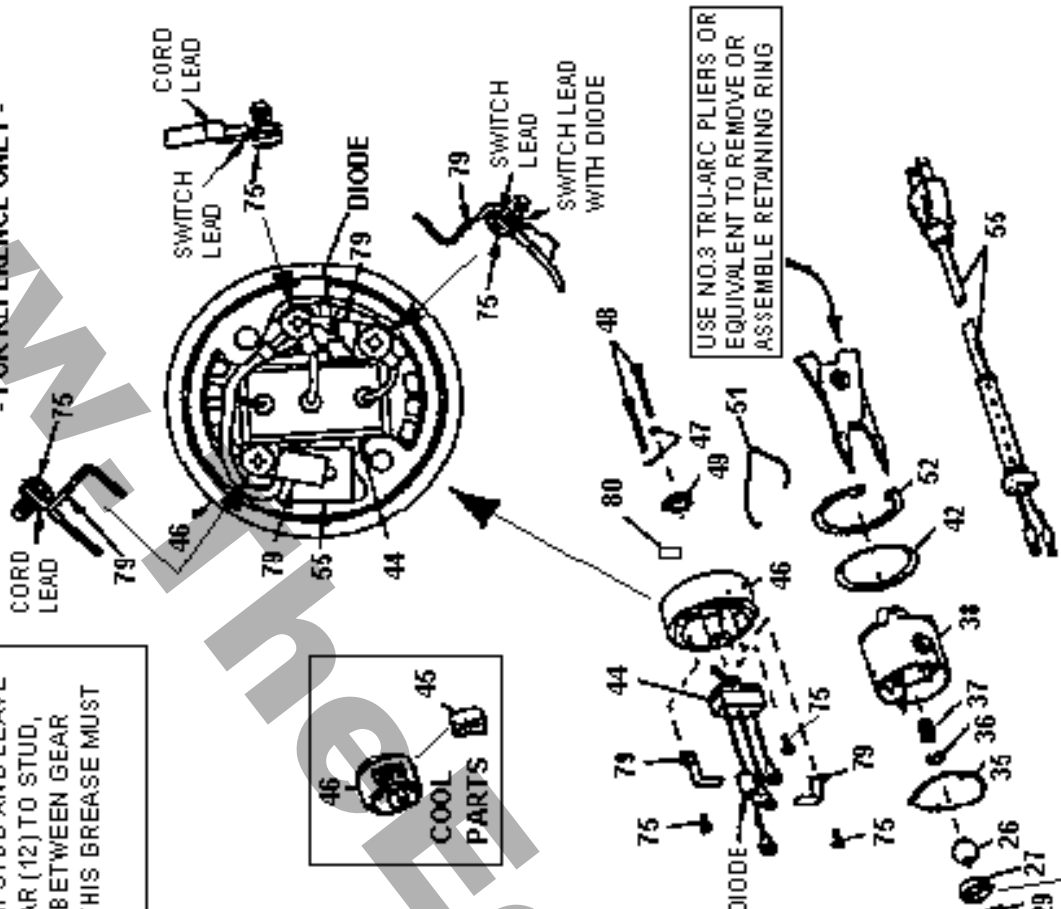

NOTE: NUMBERS SHOWN ON DRAWING ARE INDEX NUMBERS ONLY. ORDER PARTS BY CORRECT PART NUMBER.