

# WAHL CLIPPER CORP.

STERLING, ILLINOIS

DRAWN	DATE	WAHL ENGINEERING APPROVAL	DATE	TITLE:	Arco	NO.	8786-451, -550, -600,
SB	2.10.12			NO.	41854-7060 - Replaces 41854-7860, 41854-7110 - Replaces 41854-7880.	BY	-2001, -2002
DRAFT	DATE	Wahl Quality Approval	DATE	REVISIONS	02179-301 - Complete Blade Set Added	DATE	APPROVED
<input checked="" type="checkbox"/>	4.21.15			<input checked="" type="checkbox"/>	41854-7419 and 41881-7330 replace 41854-7418 (Page 2)		
SHEET	1 of 4	Wahl Service Center Approval	DATE	<input checked="" type="checkbox"/>	41854-7950 - Replaces 41854-7060, 41854-7960 - Replaces 41854-7110		
ITEM			DATE	<input checked="" type="checkbox"/>	41854-7666 and 41854-7144 replace 41854-7665 and 41854-7143	SB	4.21.15

NO.	Part #	DESCRIPTION
1	46110-0710	MSC Housing Screw
2	41854-7950	MSC Motor Only
3	41854-7666	MSC Top & Bottom Housing - Arco
4	01854-7240	MSC Top & Bottom Housing - Pink
5	41854-7960	MSC Motor / Circuit Board Complete
6	41854-7870	MSC Circuit Board - Arco
7	00114-300	Replacement Battery (NiMH)
8	02179-301	Standard Blade Set Complete - Includes 9, 10 and 11 below
9	41854-7968	MSC Cutter Blade Arco
10	41854-7144	MSC Replacement Blade Platform 5/1
11	41854-7853	Replacement lever 5/1 blade

See Page 2  
For Charger Stand and Cord/Transformer

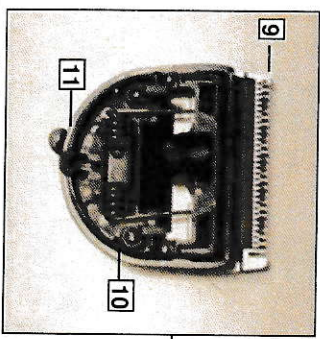
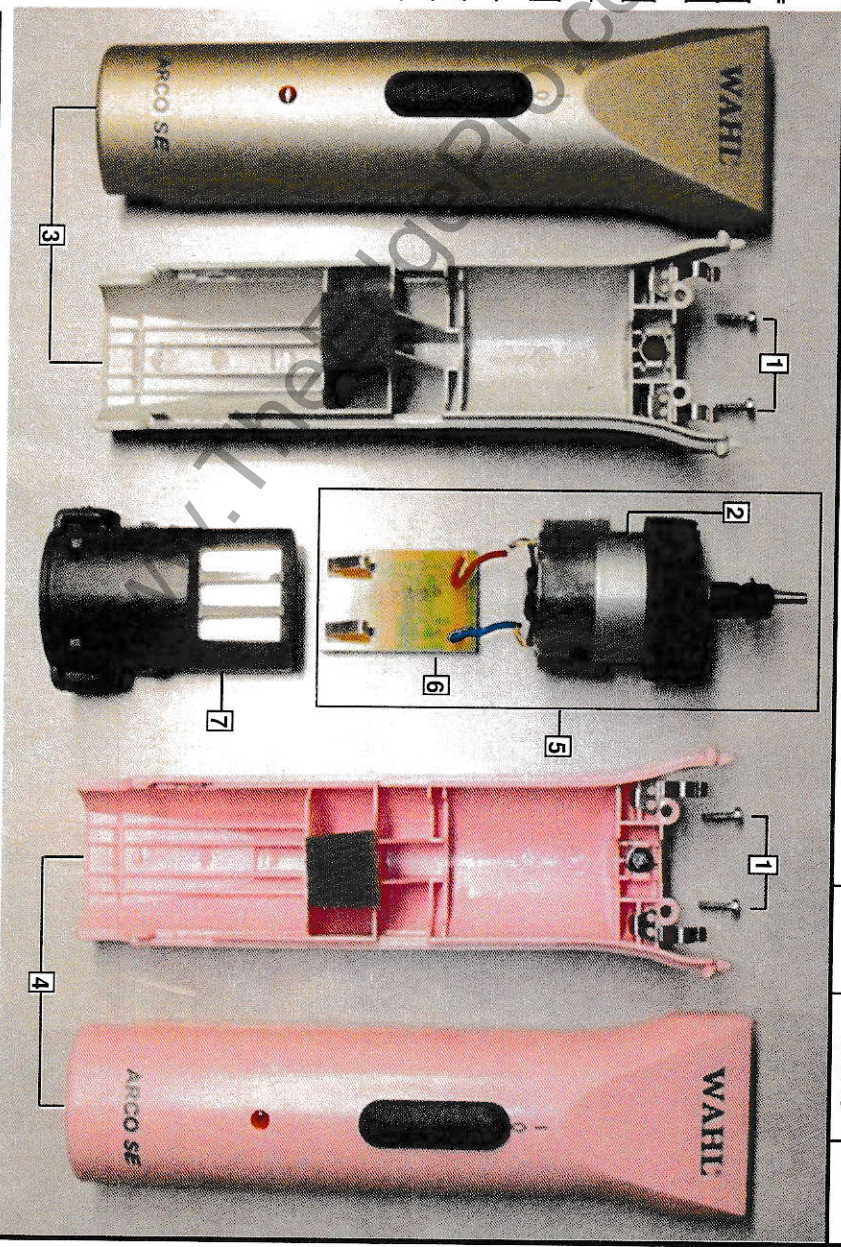

[www.TheEdgePro.com](http://www.TheEdgePro.com)